

CSP-R1040D

SERVICE MANUAL

Ver 1.0 2004. 02

AEP Model
UK Model

CSP-R1040D is respectively CDC-R104 provided with the speaker unit.

This service manual only covers the speaker unit. Refer to the appropriate service manual CDC-R104/X104/X144 for the main section.

SPECIFICATIONS

Speaker	Dual cone type Woofer 16 cm, polypropylene cone type
Maximum input power	130 W
Rated input power	30 W
Impedance	4 ohms
Sensitivity	89 dB/W/m
Frequency response	40 – 22,000 Hz
Mass	Approx. 460 g per speaker

Design and specifications are subject to change without notice.

DIMENSIONS

unit: mm

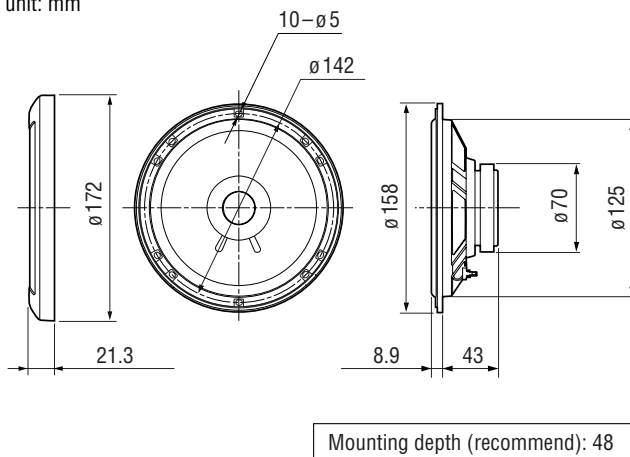

• PARTS LIST

Ref. No.	Part No.	Description	Remark
	1-544-814-32	SPEAKER (16cm)	
	3-256-934-21	MANUAL, INSTRUCTION (ENGLISH,GERMAN, FRENCH,ITALIAN,DUTCH,SPANISH,POLISH, CZECH,HUNGARIAN,RUSSIAN)	
1	3-256-189-01	TEMPLATE (A)	
2	1-574-318-71	CORD (WITH TERMINAL) (L-CH) (WHITE)	
2	1-574-318-81	CORD (WITH TERMINAL) (R-CH) (GLAY)	
3	3-240-189-11	SCREW, SPECIAL	
4	3-590-903-11	NUT, SPEED	
5	X-3383-836-1	NET ASSY, GRILLE	

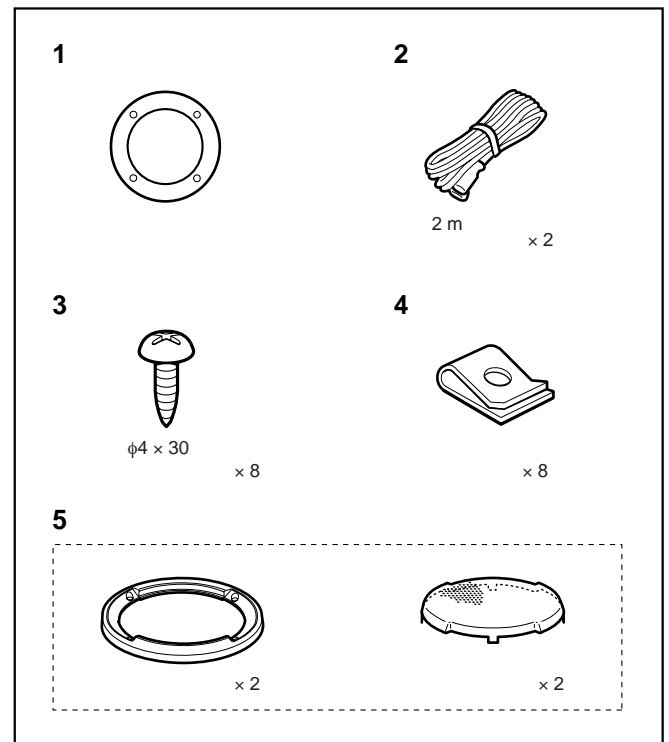

FM/MW/LW COMPACT DISC PLAYER/
DUAL CONE SPEAKER

9-877-587-01
2004B04-1
© 2004. 02

Sony Corporation
e Vehicle Company
Published by Sony Engineering Corporation

